



ALFA SRL

ZENITH D - TECHNICAL CATALOGUE

update 1.1
06/2011

CT.D3.00

- ZENITH D3 -
TECHNICAL CATALOGUE
GLASS DOOR WITH OVERPANEL AND SIDELIGHT

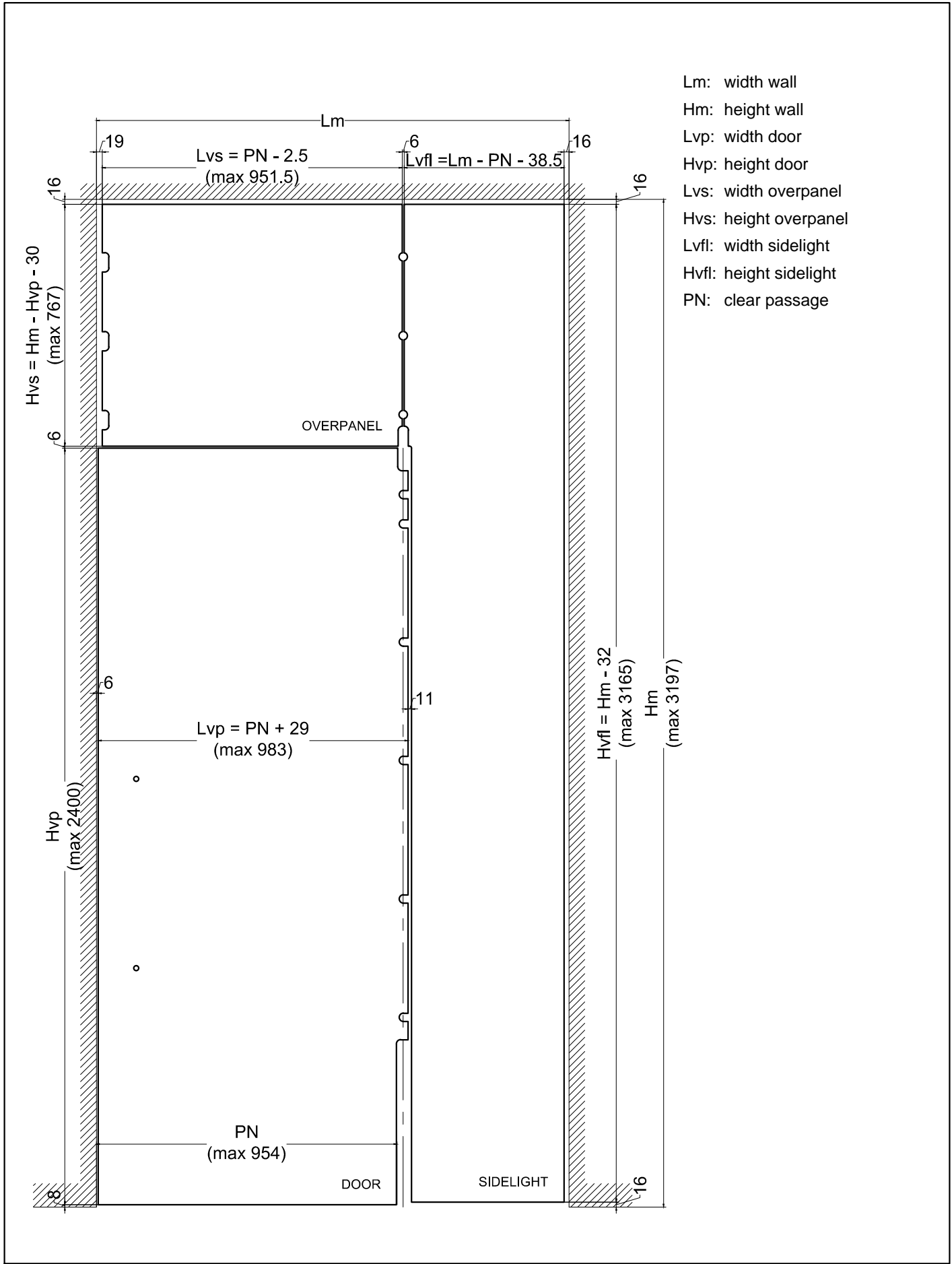

CT.D3.01	ZENITH D3 - MAXIMUM DIMENSIONS
----------	--------------------------------

Hm: height wall
Hvp: height door
Hvs: height overpanel
Hvfl: height sidelight

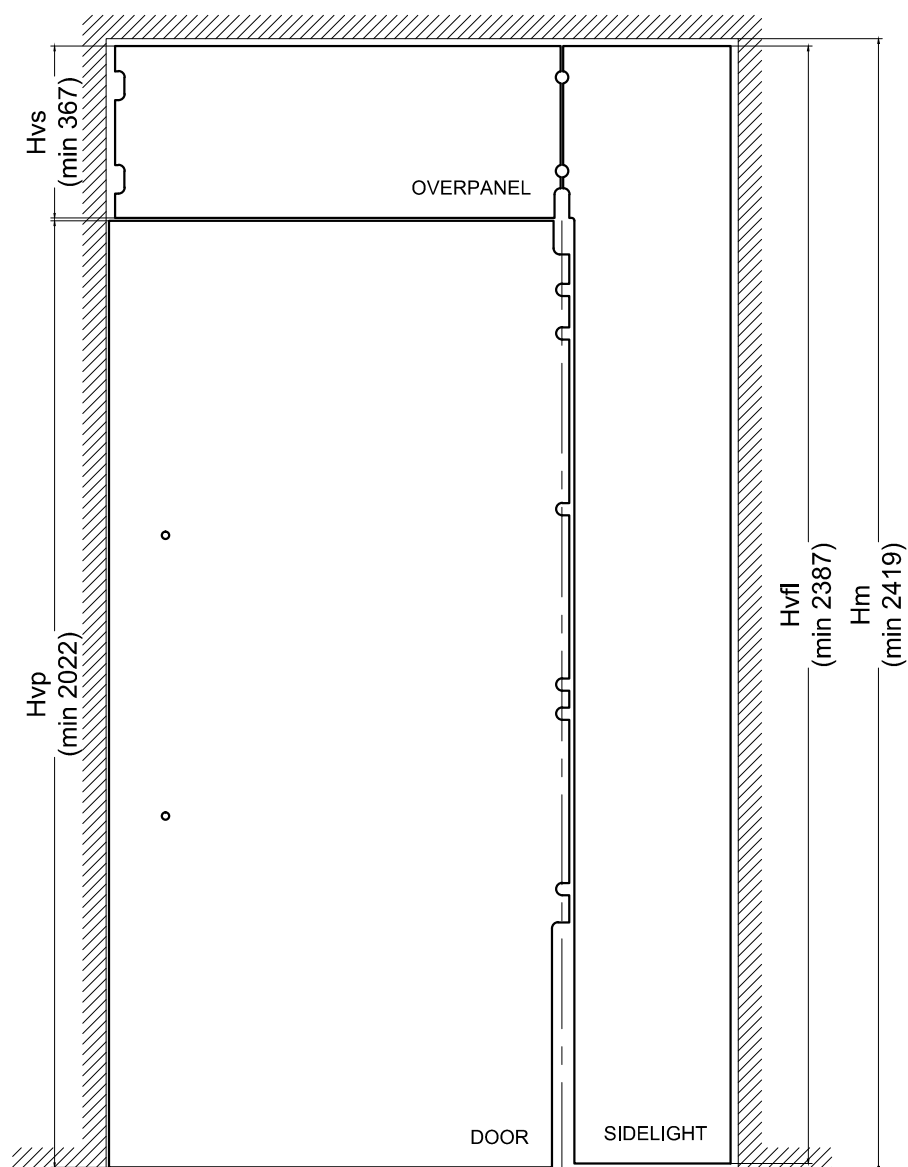

CT.D3.02

ZENITH D3 - MINIMUM DIMENSIONS

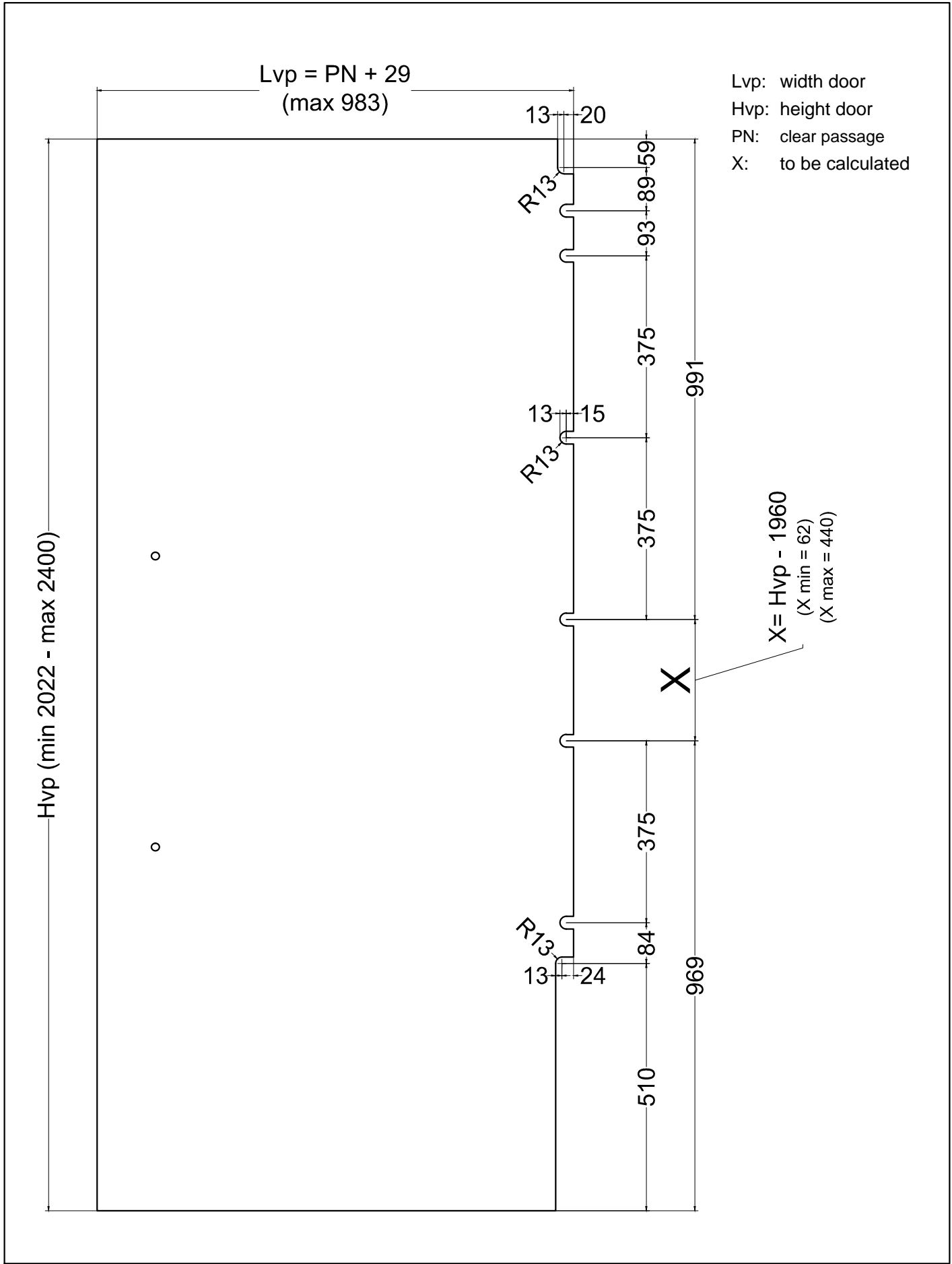

CT.D3.03	ZENITH D3 - WORKING GLASS DOOR
----------	--------------------------------

Hm: height wall
 Hvp: height glass door
 Lvs: top width glass overpanel
 Lvs1: bottom width glass overpanel
 Hvs: height glass overpanel
 Y: to be calculated
 Z: distance between holes
 PN: clear passage

ALUMINIUM BAR
 Type 1

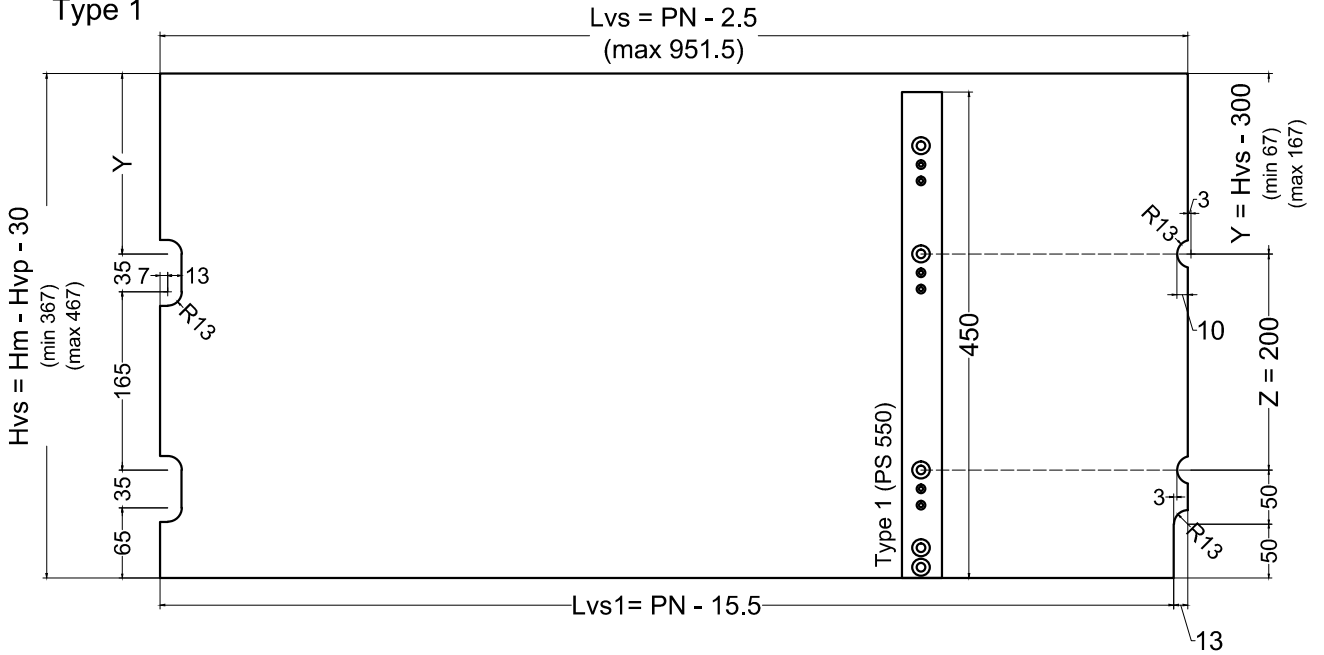

ALUMINIUM BAR
 Type 1

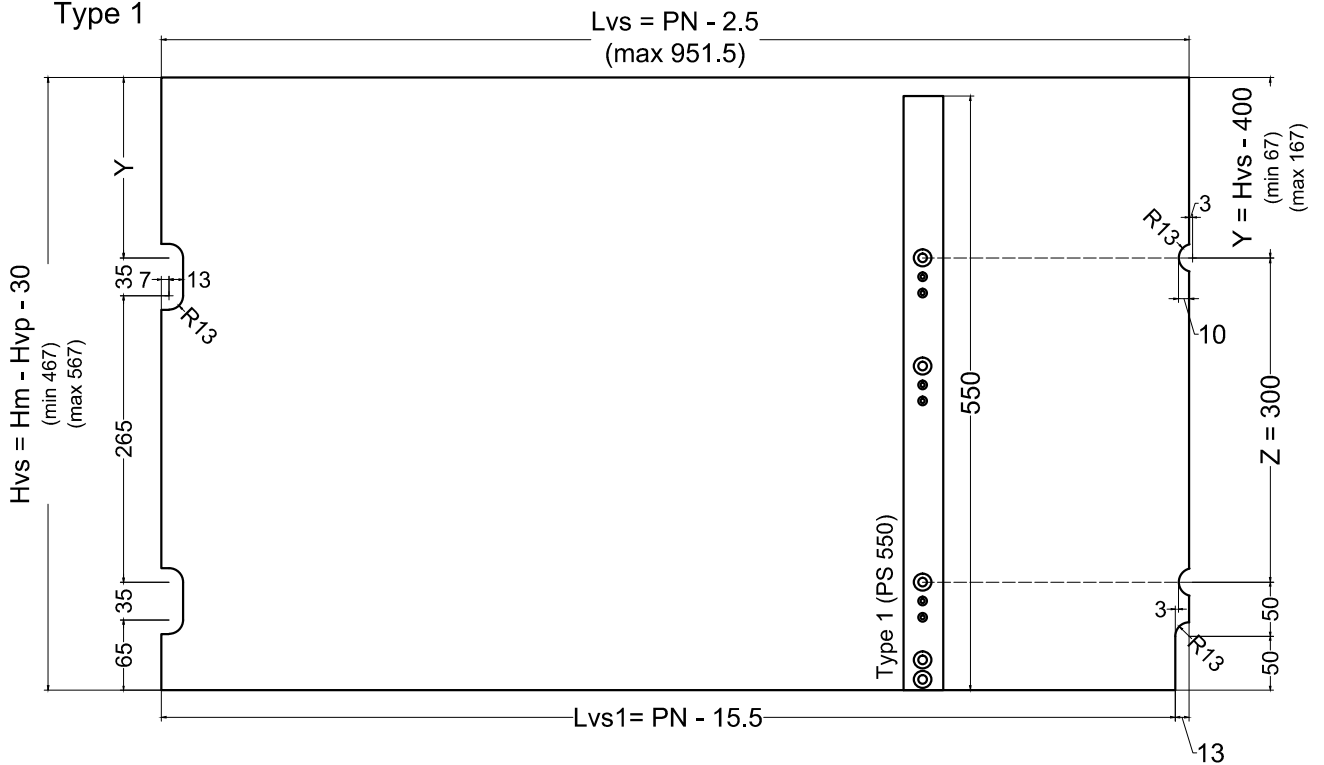

CT.D3.04

ZENITH D3 - WORKING GLASS FOR OVERPANEL
 (FROM MIN mm 367 TO MAX mm 567)

Hm: height wall
 Hvp: height glass door
 Lvs: top width glass overpanel
 Lvs1: bottom width glass overpanel
 Hvs: height glass overpanel
 Y: to be calculated
 Z: distance between holes
 PN: clear passage

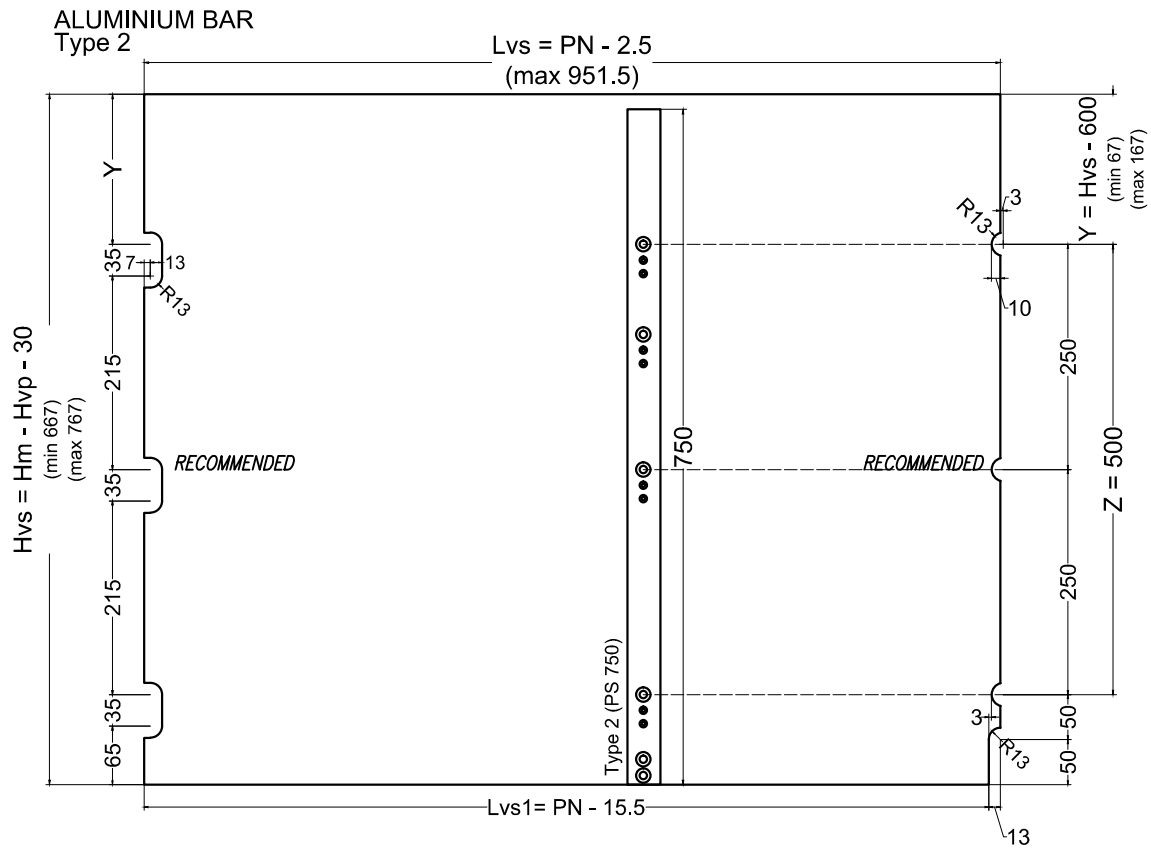
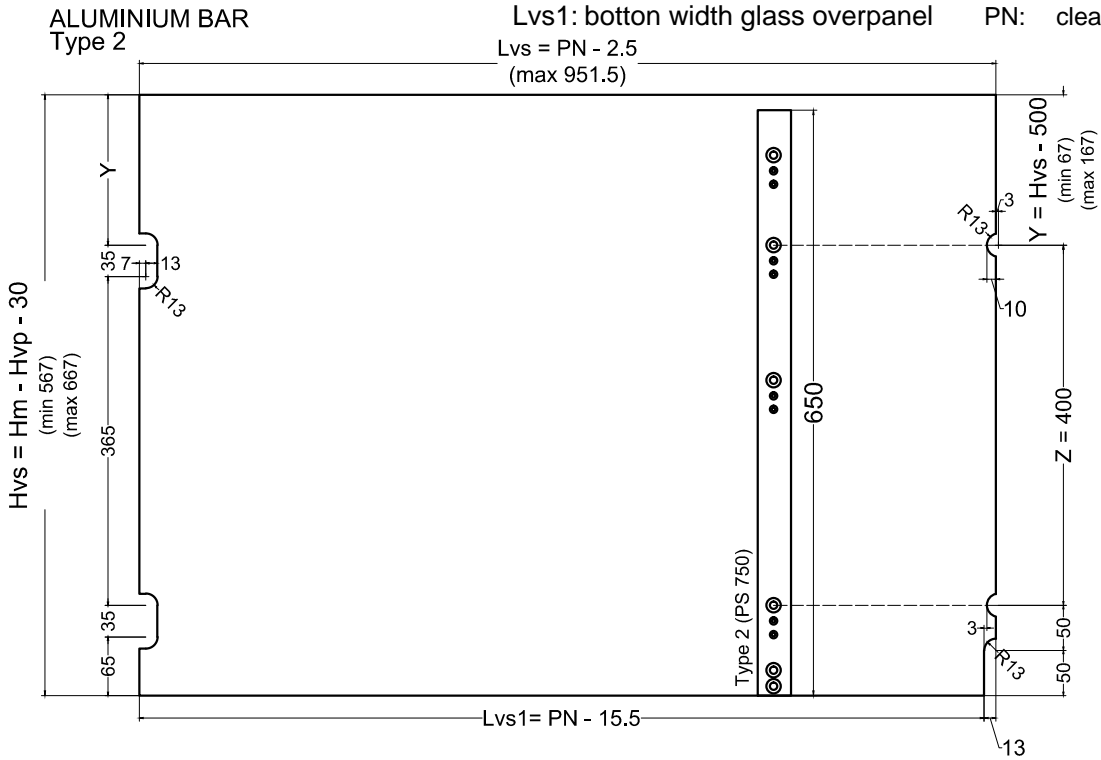

CT.D3.05

ZENITH D3 - WORKING GLASS FOR OVERPANEL
 (FROM MIN mm 567 TO MAX mm 767)

Lm: width wall
 Hm: height wall
 Hvp: height glass door
 PN: clear passage

Lvfl: top width glass sidelight
 Lvfl1: bottom width glass sidelight
 Hvfl: height glass sidelight right
 Hvfl1: height glass sidelight left

Y, Z = SEE CT.D3.04 / CT.D3.05

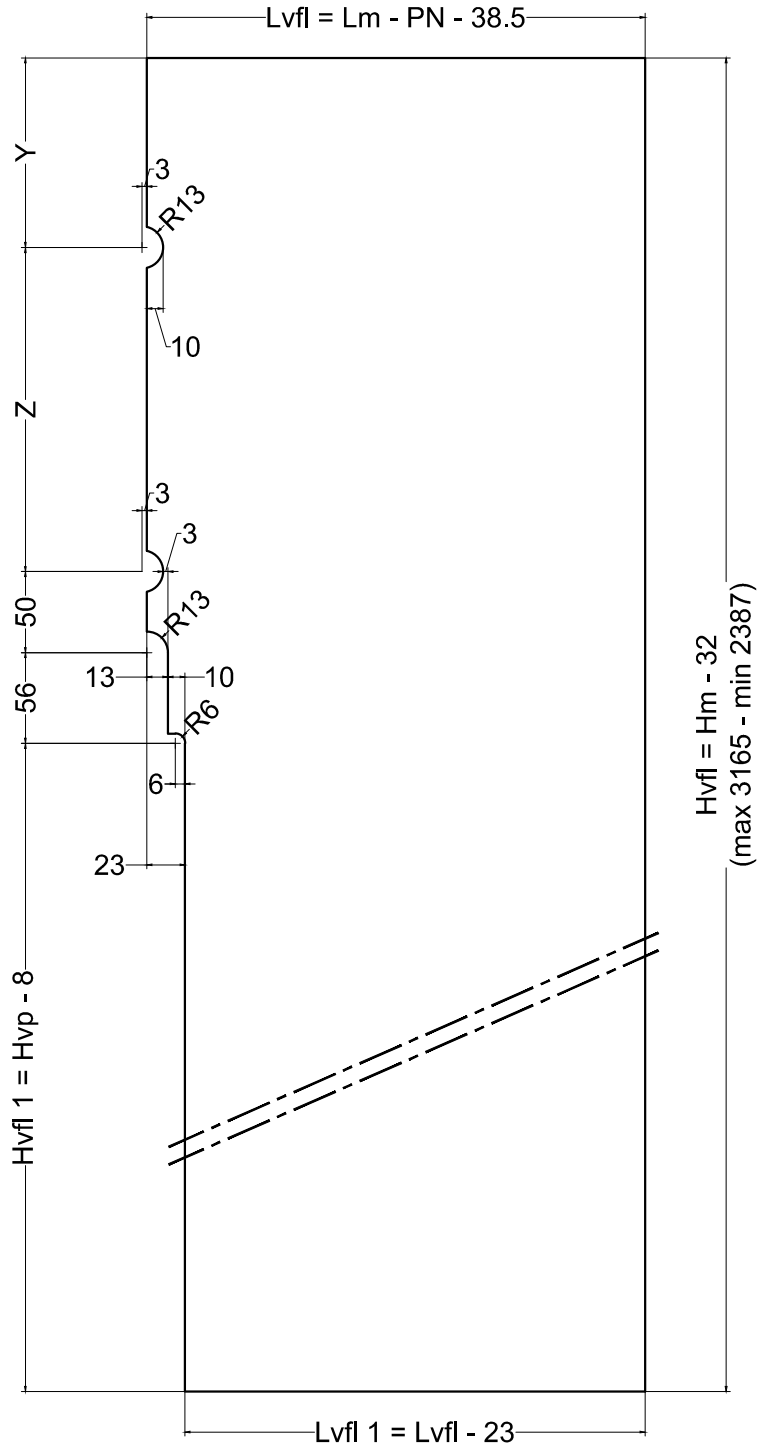

CT.D3.06

ZENITH D3 - WORKING GLASS SIDELIGHT

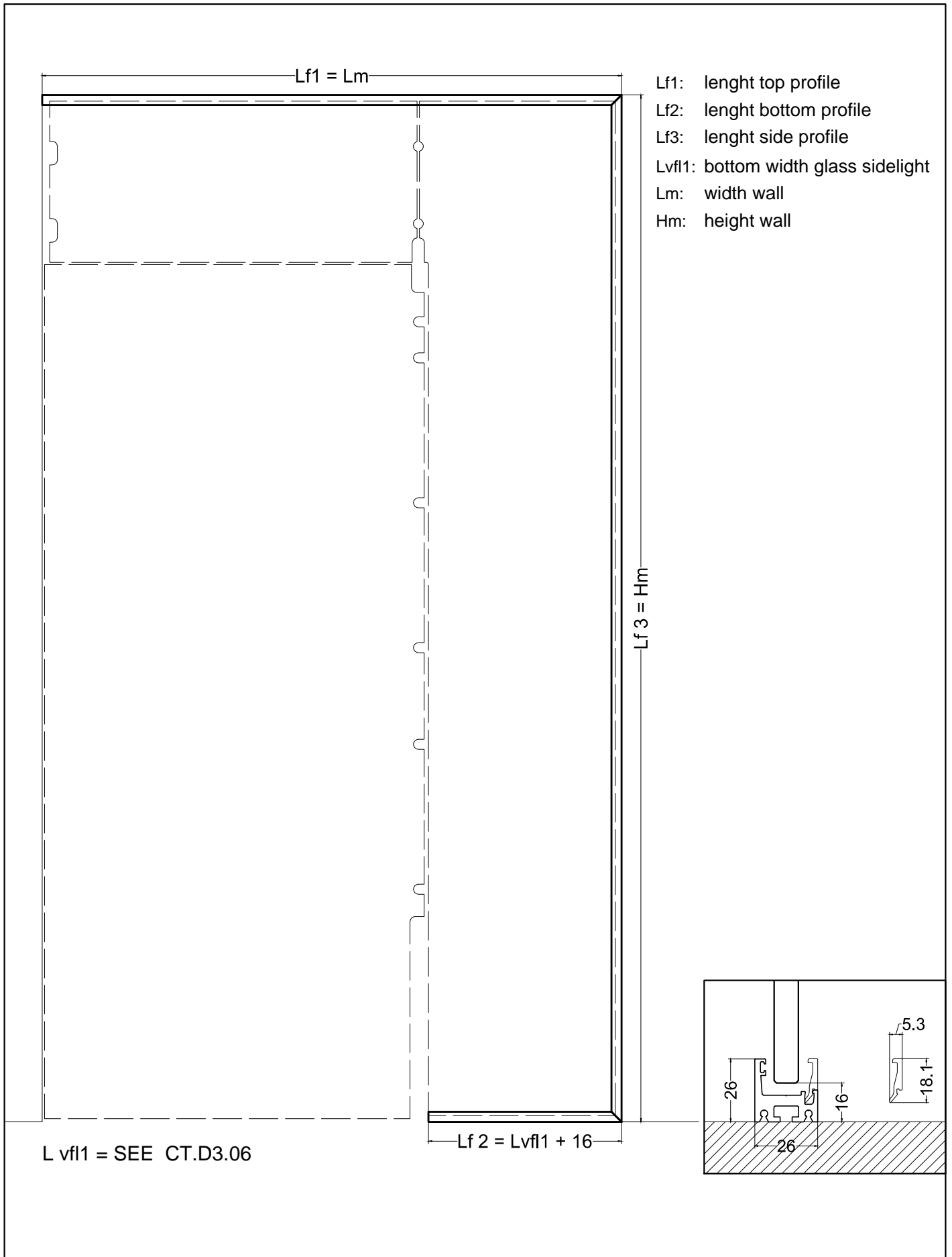

CT.D3.07

ZENITH D3 - CUTTING OF PROFILE FOR FIXED GLASS PANEL

P: length aluminium bar
Hvs: height glass overpanel

Hvs = SEE CT.D3.04 / CT.D3.05

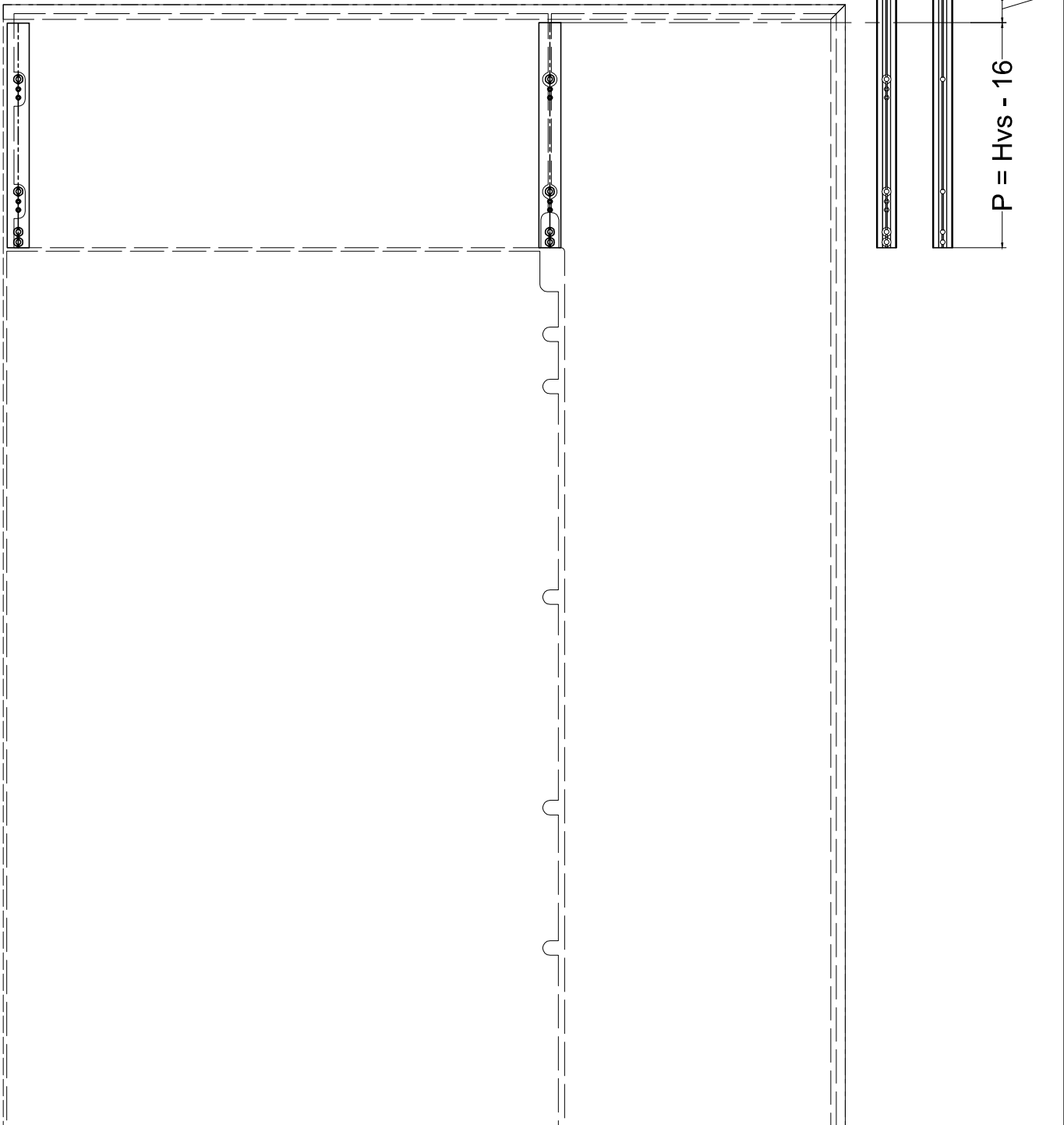

CT.D3.08

ZENITH D3 - CUTTING ALUMINIUM BAR

Hvp: height glass door

T: cutting alum. bar

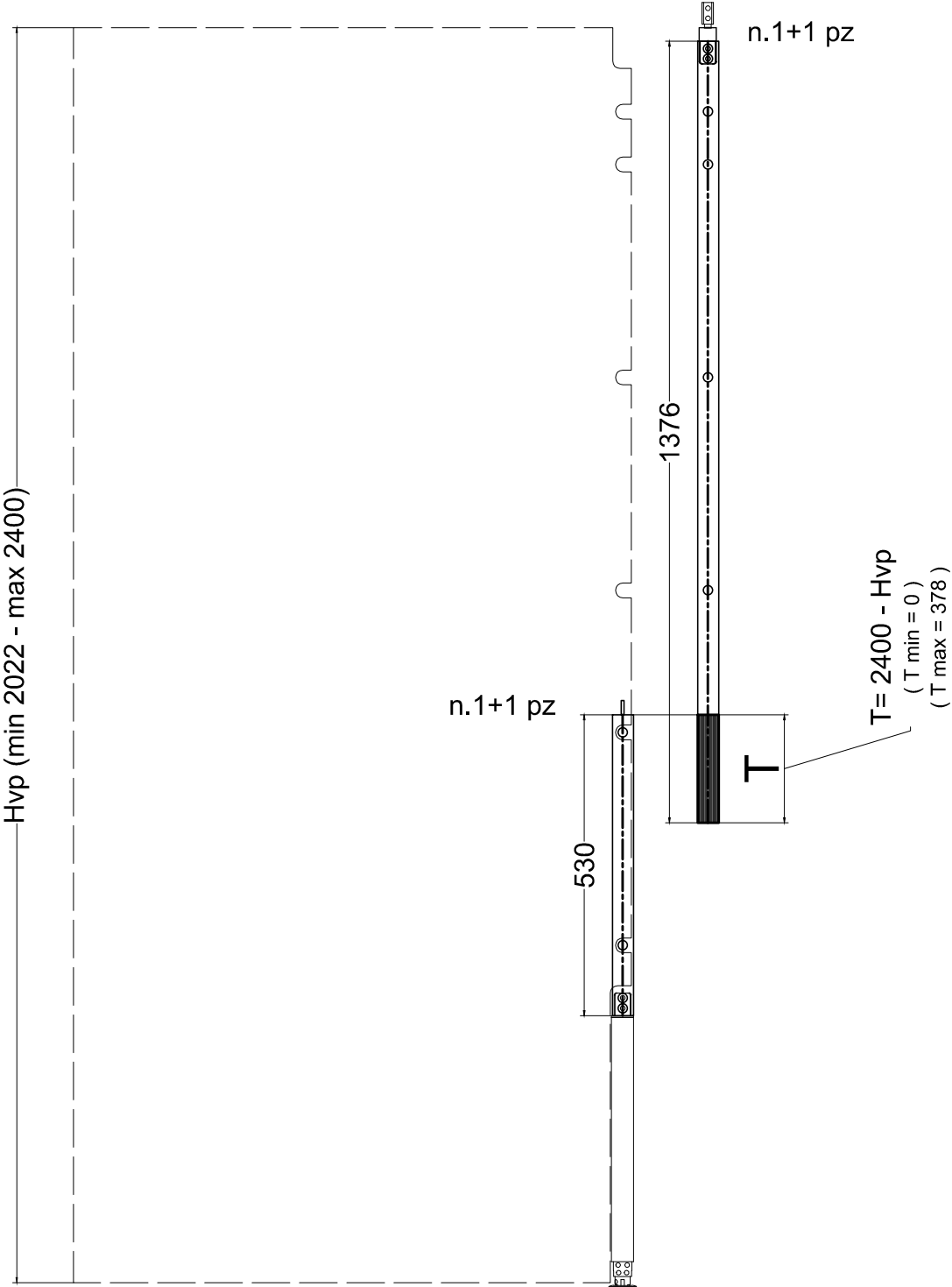

CT.D3.09

ZENITH D3 - CUTTING ALUMINIUM BAR

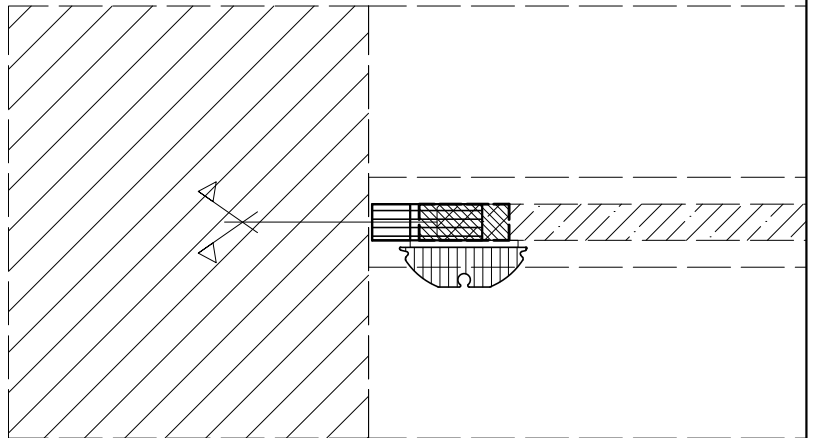
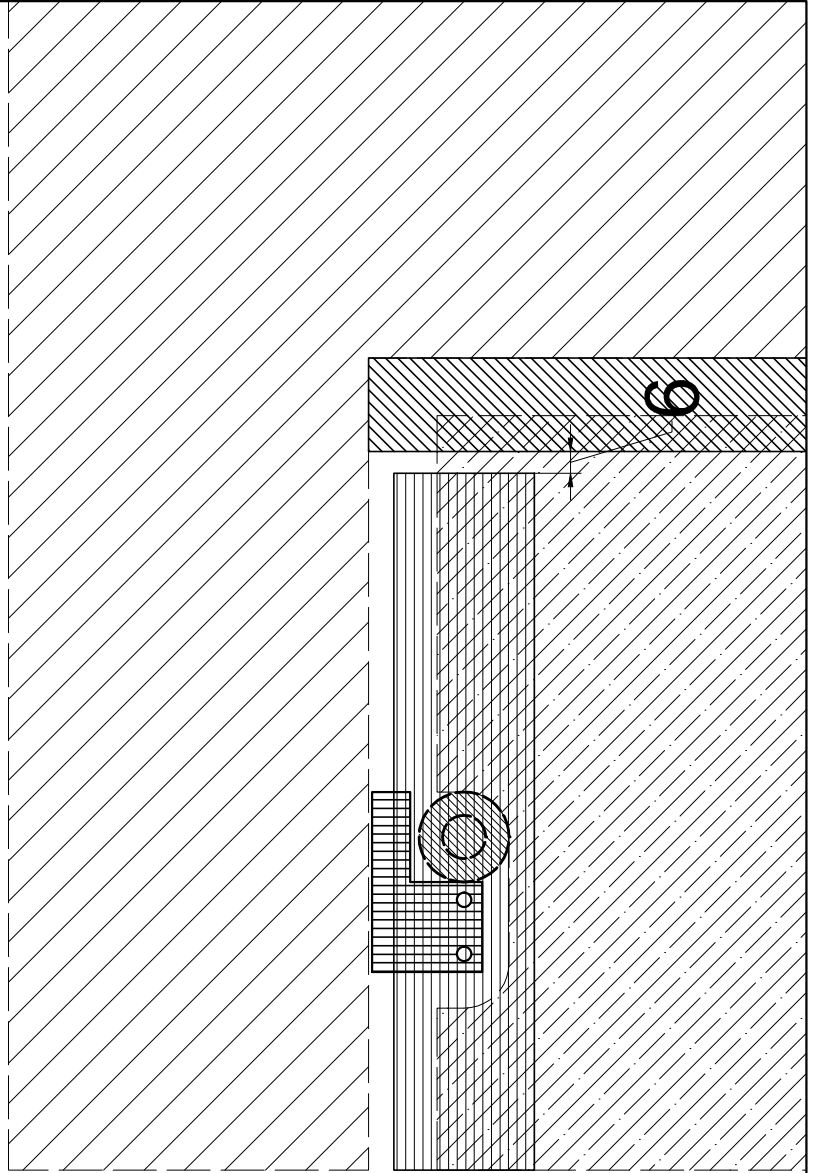
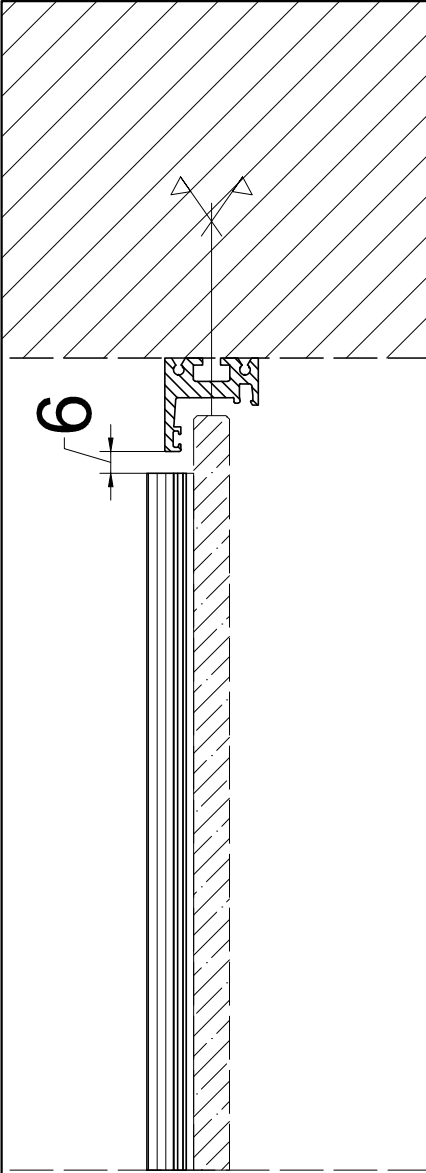

CT.D3.10

ZENITH D3 - INSTRUCTION TO INSTALL ALUMINIUM BAR AND BRACKETS